

2017
HEPBURN SPRINGS
SENIOR AMATEUR

THURSDAY 25 – FRIDAY 26 MAY

HEPBURN SPRINGS GOLF CLUB



HEPBURNSPRINGS
GOLFCLUB



PLAYER INFORMATION & DRAW

Host Club

Venue: Hepburn Springs Golf Club
Address: 36 Golf Links Rd, Hepburn Springs 3461
Phone: (03) 5348 2185
Website: www.hepburngolf.com.au

Date: Thursday 25 – Friday 26 May 2017
Format: 36-Hole Stroke (Men), Stableford (Women)

Tournament Committee

- John Evans (Hepburn Springs President)
- Neil Bruce (Hepburn Springs Captain)
- Tony Hyde (GV Senior Advisory Group Chairman)
- Stephanie Wearne (GV Golf Events Coordinator)

Event Format

Thursday 25 May (Round 1)

10:00 am Registration starts
 11:15 am Briefing
 11:30 am Play commences – Multi tee start

Friday 26 May (Round 2)

8:00 am Registration starts
 9:15 am Briefing
 9:30am Play commences – Multi tee start
 2:30 pm Tournament presentations (Approx.)

Lunch

Sandwich packs will be provided to all players both days, with drinks at each individual's expense.

Trophies

Trophies will be awarded to:

Men

- **36-Hole Gross** – Hepburn Springs Senior Amateur Champion & Runner-Up
- **36-Hole Nett** – Hepburn Springs Senior Amateur Handicap Champion & Runner-Up

Women

- **36-Hole Scratch Stableford** – Women's Hepburn Springs Senior Amateur Champion
- **36-Hole Stableford** – Women's Hepburn Springs Senior Amateur Handicap Champion

Other (Overall)

- 36-Hole Nett ball run-down
- NTP (Golf Fore a Cause) – gold coin donation

No player may win a trophy in both the stroke and nett sections. *Points will be awarded for the Men's Doug Bachli & Paul Lulofs, and Women's Senior Averages Trophies.*

Presentation

All trophies will be presented after the conclusion of play on Friday 26 May. It would be appreciated if as many competitors as possible remain for the presentation to honour the respective trophy winners.

2016 Hepburn Springs Senior Amateur Champions



L-R: Ian Frost, Helen Pascoe, Jan Thompson and John Hoare

Final Round Draw

A seeded draw will be created for the final round on the basis of round one gross scores. The final round will commence via a multi-tee start at 9:30am on Friday 26 May. The final round draw will be made available on the GV Website at www.golfvic.org.au, from approximately 6:00pm on Thursday 25 May.

Scratchings

Any player wishing to scratch prior to Monday 22 May 2017 must ring GV tournaments on 8545 6214. On the day of play call the GV mobile (Stephanie) on **0435 949 992**.

Course Map

Players are requested to familiarise themselves with the course map to avoid any delay in commencement of play from allocated holes.

HEPBURN SPRINGS GOLF CLUB

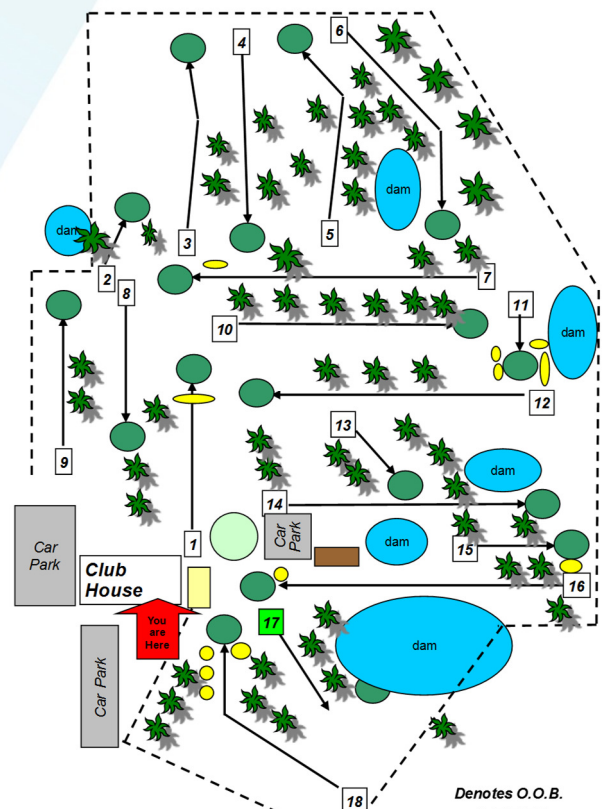

Registration

All competitors are required to report to Golf Victoria representatives inside the clubhouse at the respective clubs upon arrival at the course. Players must then be present on the appropriate tee **no later than 10 minutes prior the tee time**.

Handicaps

All players must ensure that their current and correct daily handicap is recorded on the scorecard in accordance with Rule 6-2b. Players must play from their **DAILY** handicap during the Championship, with the exception that no player shall play from a GA handicap greater than the maximum limit of 24.4 (Men) and 45.4 (Women).

In accordance with Section 17 of the GA Handicap System, the leading 30 players from the 2016 Paul Lulofs Trophy and any player within the leading 30 players of the 2016 Paul Lulofs Trophy as at March 31; June 30 and/or September 30 will be allocated a Special Competition GA Handicap.

Each player's Special Competition GA Handicap will be calculated on the basis of scores returned in Victorian Senior Order of Merit events only, in accordance with the regular calculation provisions of the GA Handicap System and updated following each Victorian Senior Order of Merit event.

For each 2017 Victorian Senior Order of Merit event, players subject to this condition are required to play from the **lower of either** their Special Competition GA Handicap or their current GA Handicap with the exception that no player shall play from a Daily Handicap greater than 24 strokes.

Scorecards

All score cards are to be returned to the registration area immediately at the conclusion of play.

Dress Regulations

All **players and caddies** are required to adhere to the Club's dress regulations with particular reference to the following: -

- ❖ Clean dress shoes **MUST** be worn in the clubhouse at all times. Athletic jogger shoes are not permitted.
- ❖ Advertising or display materials must not appear on clothing except for brand name logos.
- ❖ All shirts must have a collar.
- ❖ Tailored shorts are permitted.
- ❖ Denim clothing of any description is not permitted.

Any player not adhering to the Host Clubs' dress regulations will be prohibited from playing. Any caddie or guest not adhering to the Host Clubs' dress regulations will be requested to leave the course.

Course Care / Club Regulations

Players are reminded that sand buckets **MUST** be taken and used, pitch marks are to be repaired, and bunkers raked following play at each course. Mobile phones are not to be used in the clubhouse or on the course unless in the case of an emergency or a ruling during the round. Play will be from the nominated tee markers. Any player not complying with these requirements will be subject to action in accordance with the GV Code of Conduct.

Motorised Carts

Competitors are permitted to ride in or on a motorised vehicle during any round of the Championship. It should be noted that the hire or provision of such transport is at the competitors own expense subject to arrangements and agreements with each host club.

Slow Play

Rule 6-7 will be strictly enforced. Each group must maintain its position on the course with respect to the group preceding them. Any group with a clear hole in front of them will be considered out of position. Penalties will be issued to individuals in such groups who by their pace contribute to such delay. Warnings may not be issued prior to penalties.

Suspension of Play

In the event of heavy rain, lightning or for any other reason, the Championship Committee will be responsible for deciding whether to suspend play. The signal for suspending play will be one short siren blast. The procedure when play is suspended is outlined under Rule 6-8b. When the course is ready for play, players will be advised to return to various locations. The signal for the resumption of play will be one long siren blast.

Refunds

Any entrant may withdraw and have the entrance fee refunded provided notification is received within three working days prior to the event. Under no circumstances will entry fees be refunded after this date unless players can provide Golf Victoria supporting documents regarding their withdrawal from the event (ie. Medical certificate).

'Safe thru 18' – First Aid Information Guide for Golfers

Golf Victoria is aware that occasionally situations arise out on golf courses where first aid or emergency action is needed, and often golfers are unsure of the best way to respond.

A compact and comprehensive first aid guide titled "Safe thru 18" has been developed in a format that can easily fit into a player's bag. This guide provides information covering many situations that players may face out on course, both critical and common.

A PDF version of the 'Safe Thru 18' guide can be obtained via the following link:

<http://www.golfvic.org.au/resources>. In addition a complimentary "Safe thru 18" guide will be available for all players at registration. Additional copies can be purchased through the Golf Victoria office for \$1 per guide.



Golf Victoria stresses that "Safe thru 18" is not designed as an alternative to a first aid course and we encourage all clubs and members to consider taking a professionally delivered first aid course.

Golf Victoria Website

The Golf Victoria Website is located at www.golfvic.org.au. Complete tournament draws, preview/review articles and a full summary of results can be found within the "Senior" section of the "Championships & Events" page from the Golf Victoria homepage.

Further Conditions

For further conditions please consult the Event Entry Form and GV Standard Event Conditions.

Supporting



2017 HEPBURN SPRINGS SENIOR AMATEUR

PLAYED AT HEPBURN SPRINGS GOLF CLUB

THURSDAY 25 - FRIDAY 26 MAY

Round 1 Draw - Thursday 25 May - Multi-Tee Start at 11:30am



Hole	Surname	First Name	Home Club
1A	McCleary	Ian	Koorungal
	Thomson	Nigel	Metropolitan
	Rafferty	Dennis	Bendigo
	Kelly	John	Metropolitan
1B	Frost	Ian	Rich River
	Boehm	Kerry	Patterson River
	Davis	Gilbert	Drouin
	Bruce	Neil	Hepburn Springs
2	Bottomley	Ross	Torquay
	Charleston	Adam	Lonsdale
	Rodgers	Ian	Hepburn Springs
	House	Gary	Sanctuary Lakes
3	McConville	Stephen	Centenary Park
	Spalding	Owen	Lara
	Lucas	Graeme	Hepburn Springs
	Carroll	Steve	Heritage
4	Gull	Wayne	Hepburn Springs
	Fink	Paul	RACV Cape Schank
	Aigner	Wayne	Sandhurst
5	Egan	Neil	Hepburn Springs
	Spalding	Brian	Koorungal
	Wearne	Paul	The National
	Wood	Trevor	Rossdale
7	Cooper*	Robert	Ballarat
	Bayly*	Kerry	Koorungal
	Gilchrist*	Kevin	Hepburn Springs
	Hedwards*	Leon	Hepburn Springs
8	Barcelon	Julieta	Peninsula-Kingswood
	Lund	Vera	Koorungal
	Smith	Jan	Hepburn Springs
	Higgs	Julie	Hepburn Springs
9	Alston	Elizabeth	Winchelsea
	Thompson	Jan	Hepburn Springs
	Rodda	Shirley	Hepburn Springs

Hole	Surname	First Name	Home Club
10A	Frith	Bernard	Hepburn Springs
	Kotaridis	George	Kew
	Rickard	Trevor	Ocean Grove
	Donovan	Tony	Metropolitan
10B	Barnes	Malcolm	Neangar Park
	Ansell	Paul	Metropolitan
	Mitchell	Patrick	Eastern
	Finkelde	Keith	Latrobe
13	Wallace	Robert	Midlands
	Hyde	Tony	Patterson River
	Duivenvoorden	Ignatius	Yarram
	Baird*	Patrick	Hepburn Spring
14A	Davis	Stan	Bendigo
	Gray	Brian	Patterson River
	Ryan	Robert	Midlands
	Phillips	Wayne	Gardiners Run
14B	Powell	Garry	Hepburn Springs
	Frith	Peter	Hepburn Springs
	Hoare	John	Pakenham
	Mansour	Chris	Centenary Park
16	Hartnett	Noelle	Rossdale
	Azzopardi	Julie	Hepburn Springs
	Cowie	Tina	Tambo Valley
17	Pascoe	Helen	Buninyong
	Langford	Judy	Wodonga
	Gorin	Debbie	Koorungal
	Smith*	Beverly	Hepburn Springs
18	Harley	Heather	Koorungal
	Mobbs	Rosemary	Hepburn Springs
	Morrison	Jill	Midlands

A' groups to play first with 'B' groups to follow

NOTE: This draw is subject to minor changes due to late entries and cancellations

*Denotes players recommended to share motorised transport where possible